

Religious

Pink Sisters



Elevation

Sacred Creations

This covered walkway leads to the garden area of a convent for cloistered nuns. It was designed to match the existing limestone building. The walkway is built with conventional wood framing and covered with an EIFS coating. The structure is protected with a standing seam, architectural panel roof. At the wishes of the residents no photos of his project were taken.

Project Details

➤ Lincoln, Nebraska

➤ 700 sf

➤ Conventional Construction

➤ Project Completion: 1997

➤ The Holy Spirit Adoration Sisters (The Pink Sisters), were founded in Steyl, Holland, on December 8, 1896.

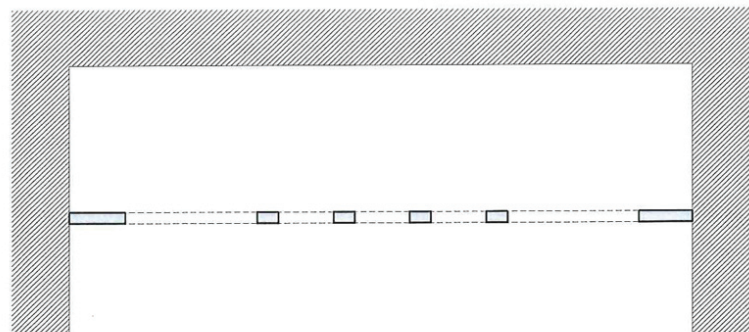

Plan